

FMA[®]

FMA630Y YACHT

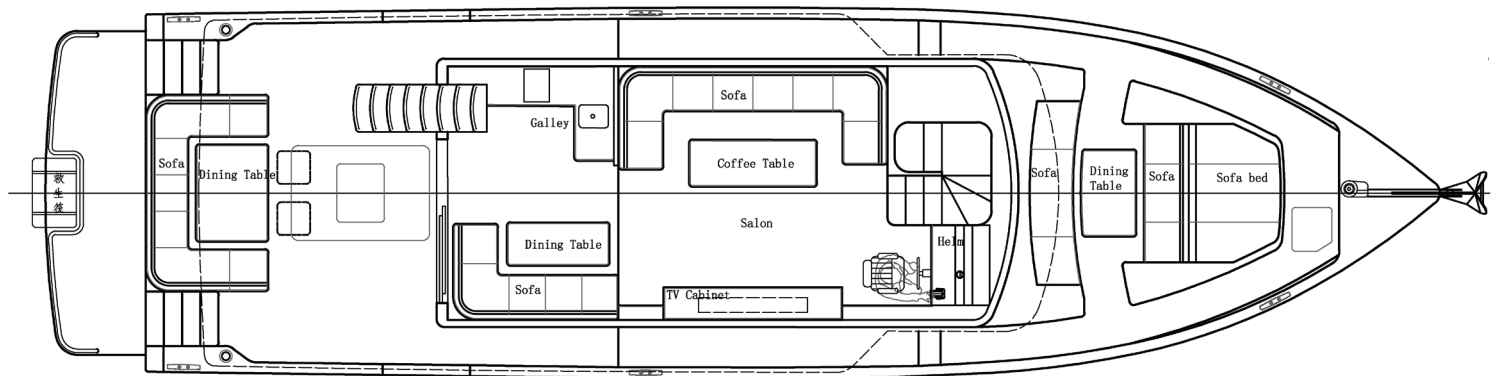

FMA630Y Yacht Specifications

	LENGTH OVER ALL	19.20M	62.99FT
	BEAM	5.00M	16.40FT
	LENGTH WATERLINE	17.05M	55.93FT
	DRAFT	0.95M	3.11FT
	LOW DRAFT	1.35M	4.43FT
	DEPTH (MLD)	2.80M	8.13FT
	DISPLACEMENT	35T	77161LB
	FUEL STORAGE CAPACITY	1200L	317GAL
	WATER CAPACITY	1000L	264GAL
	SEAWATER DESALINATION	1300L	343GAL
	ENGINE	2 x 580HP YANMAR ENGINE TOTAL-1160HP	



HULL AND DECK

Standard

Premium

- FRP with vinyl ester resin infused E-Glass uni-directional, quad axial cloth and foam core

- AOC gel coat hull and deck

- Teak inlaid transom steps with FixTech caulking

- Teak inlaid cockpit sole with FixTech caulking

- Teak inlaid side deck with FixTech caulking (SCO)

- Foam core bulkheads and cabin soles

- Bronze thru-hull fittings

- Hull and deck laminated and bonded

- 8 portlights in hull

- Double layer laminated safety glass salon windows

- Anchor and stowage lockers forward

- There is a U-shaped sofa on the foredeck

- Engine access hatches on transoms



DECK HARDWARE

Standard

Premium

- 1 opening deck hatches – Lewmar

- SS stanchions

- SS side boarding gates with pelican hooks

- SS transom handrails

- SS pulpits with seats

- SS boarding ladder on starboard transom

- 6 SS 12" cleats

- Two (2) SS 12" midship spring cleats

- 1 deck water fillers

- Deck fuel filler

- Two (2) deck waste pump outs

- 1 showers on transom

- Electric anchor windlass—Lewmar

- Anchor and 100 m (300 ft) chain

- Eight (8) fenders

- Six (6) docklines: 4 x 20 m (65.6 ft) and 2 x 25 m (82 ft)

- Seawater anchor/deck wash-down system



COCKPIT

Standard

Premium

- Large dining settee aft for 8 people

- Large dining table

- Closed cell foam settee cushions upholstered in Sunbrella fabric

- Storage under seating

- Two (2) cockpit stereo speakers

- SS boarding ladder on port transom

- Courtesy floor lighting

- A stainless steel frame for the lifeboat is installed on the stern's afterdeck.

- Main companionway double sliding door

- There is a diving platform at the stern.



FLYBRIDGE

Standard

Premium

- L settees for 8 with dining table
- Sunbrella sun pad
- Two-Seater Sofa
- All seat cushions to be Sunbrella material
- There is a bar counter with a sink on the flybridge
- Teak inlaid floor with FixTech caulking (SCO)
- Stainless steel handrails/grabrails at necessary positions
- Steering pod with oversized bench seat
- Helm to have B&G OR Raymarine suite and full controls
- Two (2) marine stereo speakers linked to cockpit/salon stereo
- FRP top

SALON	Standard	Premium
● Panoramic view through large fixed windows		
● Dining settee to starboard		
● Inlaid wood dining table		
● galley convenient to salon and cockpit		
● Granite counter tops with Kohler sink		
● Embedded marine refrigerator		
● 2 electric stove/oven – Electrolux		
● Microwave/oven-Electrolux		
● FRP cabinets		
● Custom storage		
● Large u-Shaped Sofa Equipped With a Coffee Table		
● Entertainment center with LCD TV, CD player and 4 speakers		
● 1 cabin access companionways		
● steering pod with bench seat		
● Helm to have Raymarine suite and controls		
● Leather interior upholstery		
● Headliner combination wood battens, FG and vinyl		
● SS accent overhead lighting		
● Courtesy floor lighting		
● Solid natural teak cabin sole		



MASTER STATEROOM

Standard

Premium

- Double berth

- Two Nightstands

- Storage under berth

- Large hanging locker with shelf storage

- There is a long tabletop below the porthole

- There is a vanity table in front of the bed

- SS overhead light fixtures

- SS reading light

- Courtesy floor nightlight

- Panoramic forward and side view through fixed windows

- Solid natural teak or hardwood cabin sole



MASTER HEAD AND SHOWER

Standard

Premium

- Shower compartment FRP

- Electric flush toilet -albinus

- Granite counter top with basins

- FRP cabinet

- Mirror

- SS accent overhead LED light fixture

- Courtesy floor nightlight

- SS tissue roller

- SS towel/clothing loops and hooks



STATEROOMS

Standard

Premium

- Double berth
- Two Nightstands
- Storage under berth
- Large hanging locker with shelf storage
- There is a long tabletop below the porthole
- There is a vanity table in front of the bed
- SS overhead light fixtures
- SS reading light
- Courtesy floor nightlight
- Panoramic forward and side view through fixed windows
- Large overhead hatch with shade and screen – Lewmar
- Solid natural teak or hardwood cabin sole



STATEROOMS HEADS AND SHOWERS

Standard

Premium

- Shower compartment FRP

- Electric flush toilet -albinus

- Granite counter top with basin

- FRP cabinet

- The shower room is fitted with a tempered glass door

- Mirror

- SS accent overhead LED light fixture

- Courtesy floor nightlight

- SS tissue roller

- SS towel/clothing loops and hooks

VIP CABIN

Standard

Premium

- Double berth
- Drawer storage under berth
- Clothes closet with more hanging space
- SS overhead light fixtures
- SS reading light
- Courtesy floor nightlight
- Portlight
- Solid natural teak or hardwood cabin sole

HEADS AND SHOWERS

Standard

Premium

- Shower compartment FRP
- Electric flush toilet -albinus
- Granite counter top with basin
- SS accent overhead LED light fixture
- Courtesy floor nightlight
- SS tissue roller
- SS towel/clothing loops and hooks



SAILOR'S QUARTERS AND HEADS

Standard

Premium

- Two Single Beds

- Drawer storage under berth

- Clothes closet with more hanging space

- SS overhead light fixtures

- SS reading light

- Courtesy floor nightlight

- Portlight

- Solid natural teak or hardwood cabin sole

- Shower compartment FRP

- Electric flush toilet -albinus

- Granite counter top with basin

- SS accent overhead LED light fixture

- Courtesy floor nightlight

- SS tissue roller

- SS towel/clothing loops and hooks

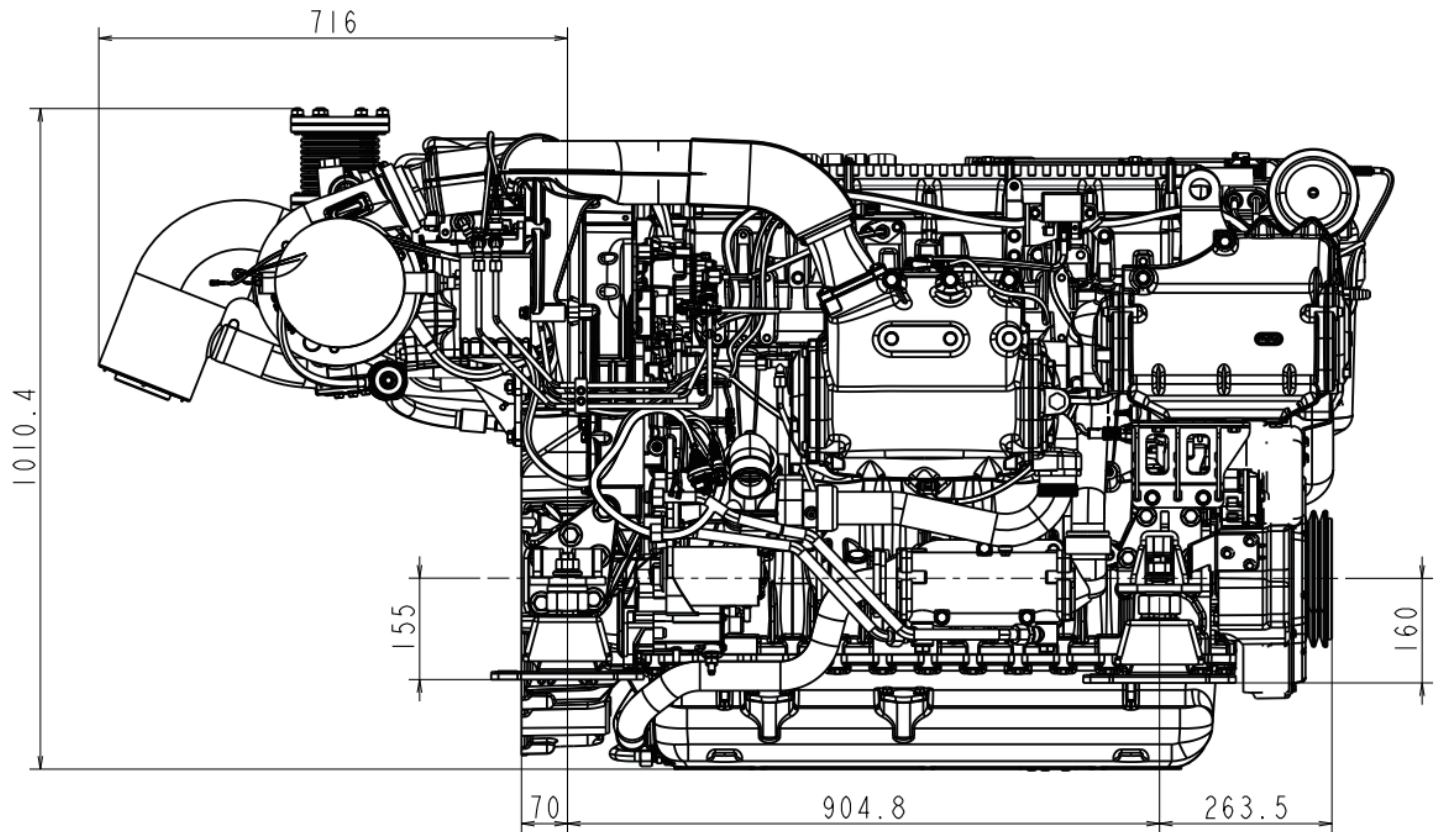

ENGINE AND MACHINERY

Standard

Premium

- Twin Yanmar 580 HP diesel engines
- 2 ZF305-3A gearboxes
- Engine instrument panel at helm position
- 316 stainless steel fuel tank 3000 liters (792 gallons)
- Fireboy automatic fire extinguishers in engine rooms

PLUMBING

Standard

Premium

- 5 automatic bilge pumps (1,100 GPH each)
- 1 manually operated bilge pumps 35 liters/min
- Hot and cold pressure water system
- Fresh Water Tanks With 1,000 Liter Total Capacity (264 Gallons)
- 40 liter hot water heaters
- Black water tanks (250 liter tanks)
- Black water direct overboard discharge via "Y" valve and pump out through deck pump-out fitting
- Main water maker – Rainman 360 GPD or similar
- Showers on transom

NAVIGATION AND ELECTRONICS

Standard

Premium

- Compass at each helm with light and dimmer
- B&G OR Raymarine RAY63 VHF radio at navigation station
- B&G OR Raymarine handheld radio
- B&G OR 2 Raymarine AXIOM2 PRO 12 or similar chart plotter – one at each helm
- B&G OR Raymarine RS150 GPS sensor interfaced with MSD
- B&G OR Raymarine P70S series autopilot interfaced with MSD
- B&G OR Raymarine autopilot remote for use at navigation station
- B&G OR Raymarine RD418HD 4 kW radar

ELECTRICAL

Standard

Premium

- Voltage: 24v DC
- (Prime) Kohler 18 kw, 120/220v AC, 50 Hz generator
- (Standby) Kohler 9 kw, 120/220v AC, 50 Hz generator
- Inverter/charger 24v DC, 2500 watt, 130 amp, 120v AC
- Dometic Chiller air-conditioning system total minimum 68,000 BTU
- Custom 24v DC/120/220v AC electrical distribution panel with circuit breakers
- Battery combiner integrated with the electrical system
- Shore power provides 220v AC
- Batteries to be sealed gel type: house and engine starting
- House: 4 deep cycle total 1200AH to run all domestic services
- Generator and Engines start batteries: two (3) 200AH batteries
- Battery charging from high output alternators
- Wiring - all marine cables to be Lloyds, ABS or CE approved
- Mast wiring run in plastic conduits
- Battery charging from high output alternators or shore power receptacles
- Lighting throughout will be 24v DC
- Mast lights: navigation lights, anchor light, steaming light, tri-color and two deck lights
- Twelve (18) electrical outlets throughout
- 50 foot shore power cords with Hubble fittings
- Alarm system: environment - high bilge, fire/smoke/heat alert; machinery - high water temp, low oil pressure on main engine; high oil temp and low oil pressure on transmission and reduction gear

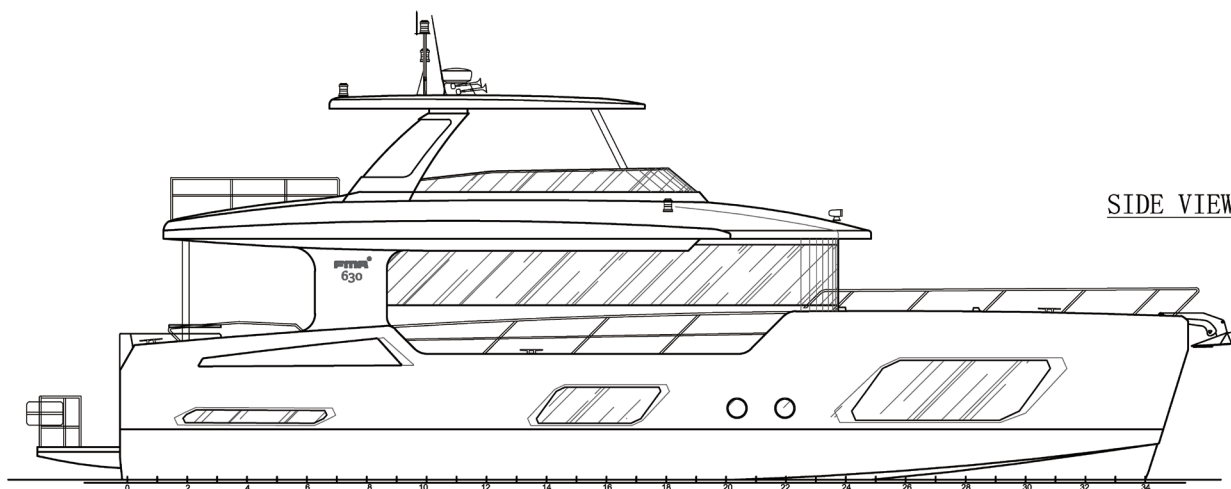

SIDE VIEW

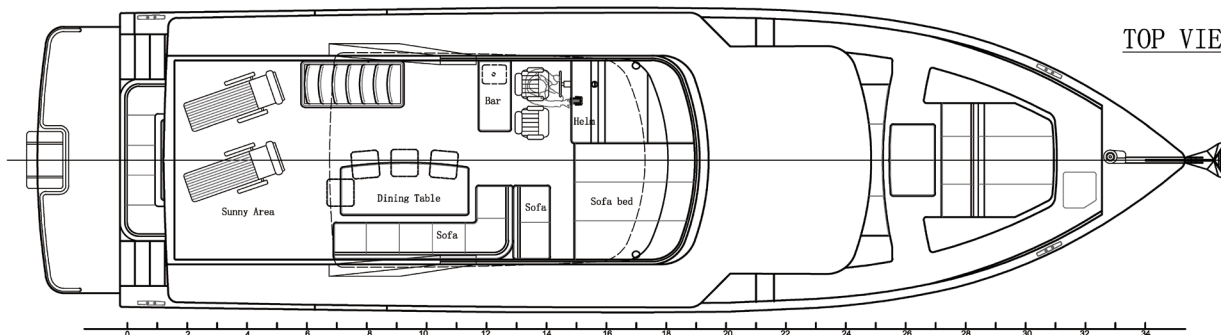

TOP VIEW

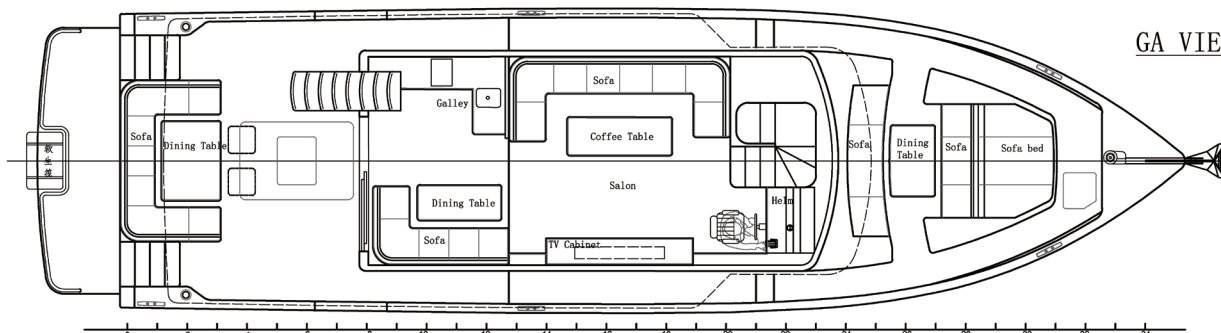

GA VIEW

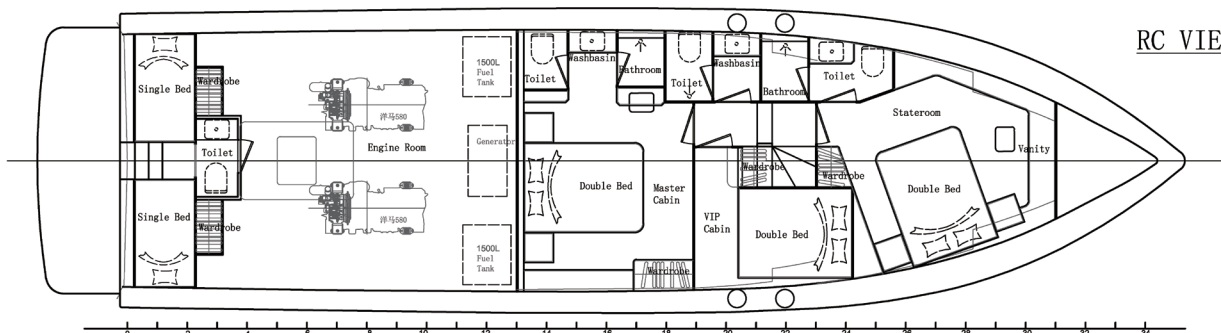

RC VIEW

PARAMETERS

MAX LENGTH:	19.20M	62.99Ft
HULL LENGTH:	17.73M	58.17Ft
LENGTH OF WATERLINE:	17.05M	55.93Ft
HULL BREADTH (MLD):	5.00M	16.40Ft
DEPTH (MLD):	2.80M	9.18Ft
DESIGN DRAFT:	0.95M	3.11Ft
FULL-LOAD DISPLACEMENT:	35.0T	77161LB
ENGIN POWER OF PROPELLER:	2×YANMAR 580HP	
SHIP SPEED:(about)	46KM	25节

						FMA630 YACHT			TECHNICAL DESIGN									
						GENERAL DRAWING			CZ630-100-02									
MARK		QUANTITY		REVISION NO					SIGN		DITE		DRAWING MARK		QUALITY		RATIO	
DESIGN				CAD														
PROOFREAD																		
LABEL INSPECTION																		
AUDIT																		
DETERMINE						DITE												
						ZHONGSHEN CHINA			WWW.FMABOAT.COM									

INTERIOR FINISH

Standard

Premium

- Hull interior surfaces to be leather covered
- Salon and stateroom upholstery to be from a selection of leather fabrics
- Wood veneer color options
- Cushions for settees to be of high grade foam of 75-100 mm
- Mattresses to be latex

GENERAL

Standard

Premium

- Antifouling paint

Specifications and component part manufacturers are subject to change. All dimensions, sizes and volumes listed are approximate. The shipyard reserves the right to modify any specifications without notice.



EXPLORE THE BOUNDLESS, ENJOY LUXURY
– BOAT VIBRATION YACHTS

FMA630Y

Embark on an ultimate sea journey

